

Flat 15, Barry Court Barry Court, Palatine Road, Didsbury, Manchester, M20 3LQ



JP&Brimelow
ESTATE AGENTS

Offers In The Region Of £150,000

 1  1  1  C

VIDEO TOUR AVAILABLE A well-kept and light, DOUBLE BEDROOM ground floor apartment. Located within this purpose-built development, set back from Palatine Road. Within walking distance to both Didsbury Village and Burton Road in West Didsbury. Boasting excellent transport links with the motorway network and the Metrolink station on Lapwing Lane, giving you direct access into the city centre, Manchester International Airport and Media City. The well-planned accommodation consists of a communal entrance hallway with stairs leading to all floors, a private entrance hallway, a studio room leading to a fitted kitchen and a three-piece bathroom completes this apartment. The property benefits from electric heating and externally the property is set in well-maintained lawned grounds with off road parking available to the rear for residents. OFFERED WITH NO VENDOR CHAIN.





EPC Chart

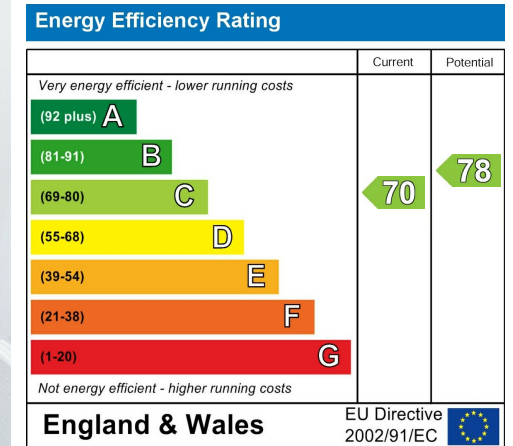

Tenure: **Leasehold** Council Tax Band: **A**

Ground Floor

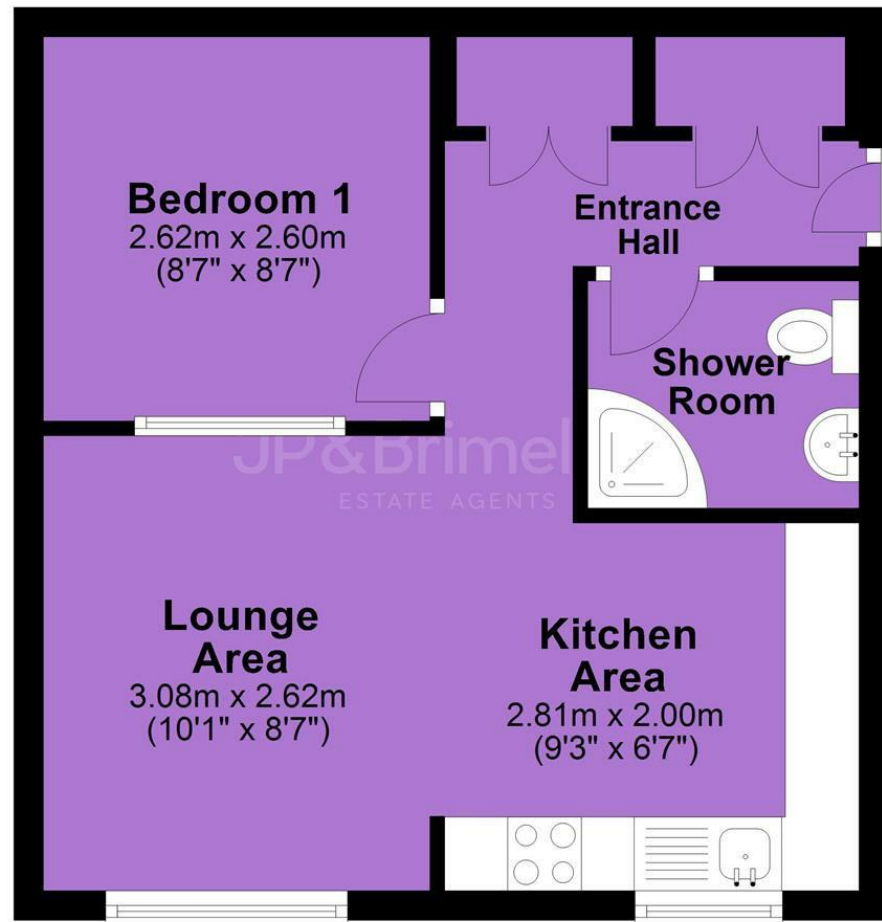

JP & Brimelow Estate Agents Ltd
430 Barlow Moor Road, Manchester, M21 8AD
Tel: 0161 8822233
E: sales@jpbrimelow.co.uk www.jpandbrimelow.co.uk



JP & Brimelow
ESTATE AGENTS

NOTICE: JP & Brimelow Estate Agents Ltd for themselves and for the vendors or lessors of this property whose agents they are give notice that:

- (i) the particulars are set out as a general outline only for the guidance of intending purchasers or lessees, and do not constitute, nor constitute part of, an offer or contract;
- (ii) all descriptions, dimensions, references to the condition and necessary permissions for use and occupation, and other details are given in good faith and are believed to be correct but any intending purchasers or tenants should not rely on them as statements or representations of fact but must satisfy themselves by inspection or otherwise as to the correctness of each of them;
- (iii) no person in the employment of JP & Brimelow Estate Agents Ltd has any authority to make or give any representation or warranty whatever in relation to this property.

jpandbrimelowestateagents

@jpandbrimelow